

**50Hz**



# **GENERAL CATALOGUE**

**Edition 2022**

[www.pentax-pumps.it](http://www.pentax-pumps.it)

# Where there's water there's Pentax



Viale dell'Industria, 1  
37040 Veronella (VR) - Italia  
Tel. +39 0442 489500  
Fax +39 0442 489510  
com@pentax-pumps.it  
[www.pentax-pumps.it](http://www.pentax-pumps.it)

**PENTAX s.p.a.**





Drainage pump with "Double-Channel" impeller for pumping charged waters and liquids with suspended solids; ideal for civil and household applications.

| Construction features  |  |
|--|--|
| <b>Pump body</b>   | cast iron  |
| <b>Shell, motor cover, base support</b>  | stainless steel  |
|  <b>Impeller</b> | stainless steel  |
| <b>Mechanical seal</b>   | double seal with oil barrier; silicon carbide on pump side, sealing ring on motor side |
| <b>Motor shaft</b>   | stainless steel AISI 430   |
| <b>Passage of solids</b>   | Ø max 50 mm  |
| <b>Depth of immersion</b>  | max 5 m  |
| <b>Liquid temperature</b>  | 0 - 40 °C  |
| <b>Cable</b>   | H07 RNF, 10 m  |
| <b>G</b>   | float switch   |

| Motor                          |   |
|--------------------------------|---|
| <b>2 Poles induction motor</b> | 3- 3x400V-50Hz<br>1- 1x230V-50Hz<br>(with thermal protection) |
| <b>Insulation class</b>        | F   |
| <b>Protection degree</b>       | IPX8  |

| TYPE | LOTS        |          |             |          |
|------|-------------|----------|-------------|----------|
|      | TRUCK       |          | CONTAINER   |          |
|      | PALLET (cm) | N° pumps | PALLET (cm) | N° pumps |
| DB   | 80×120×160  | 51       | 80×120×160  | 51       |



**DB**

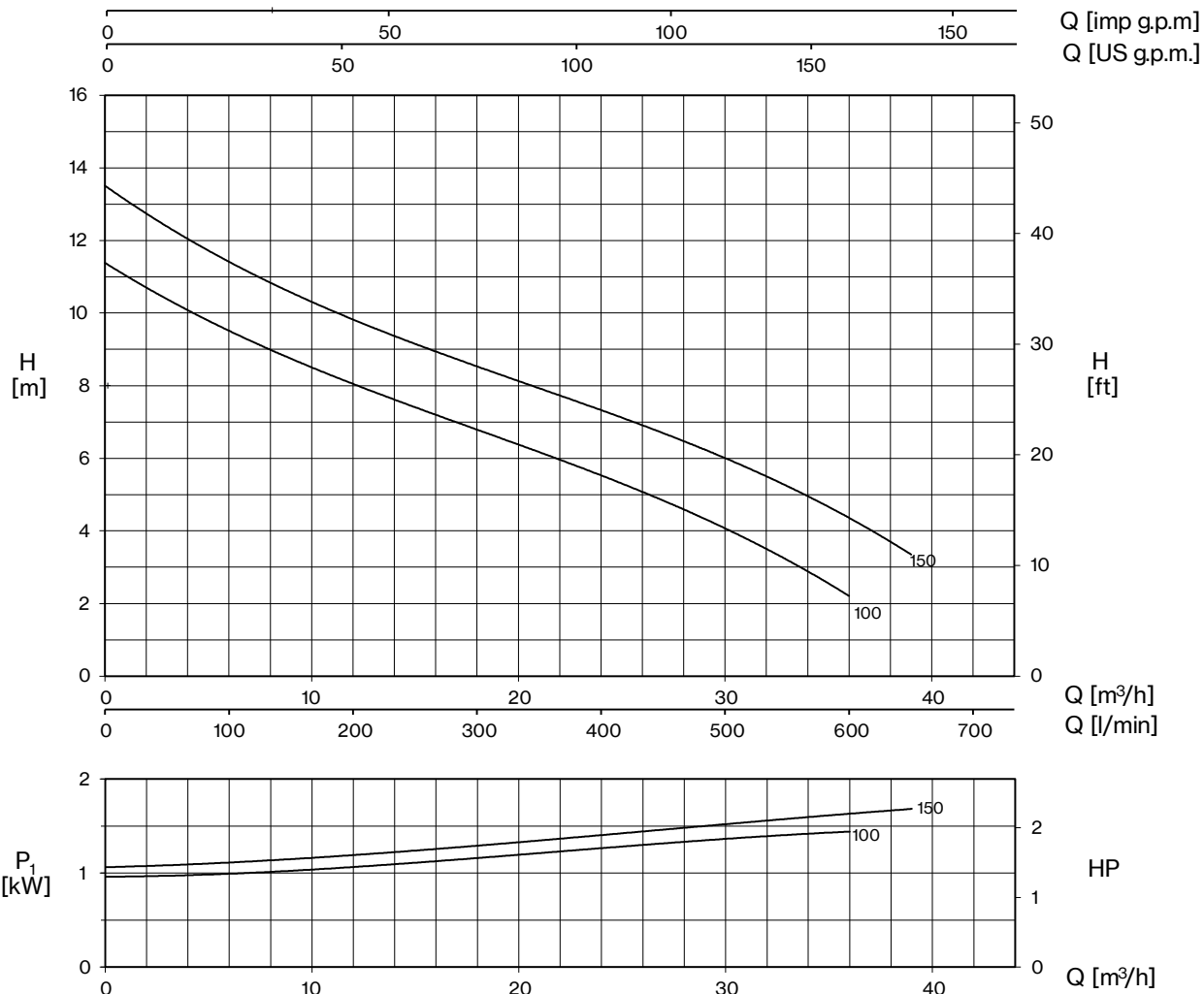

| TYPE       |         | W    | AMPERE |     | Q (m³/h - l/min) |       |     |     |     |     |     |     |  |
|------------|---------|------|--------|-----|------------------|-------|-----|-----|-----|-----|-----|-----|--|
| 1~         | 3~      |      | 1~     | 3~  | 0                | 6     | 12  | 18  | 24  | 30  | 36  | 3   |  |
|            |         |      |        |     | 0                | 100   | 200 | 300 | 400 | 500 | 600 | 650 |  |
|            |         |      |        |     |                  | H (m) |     |     |     |     |     |     |  |
| DB 100 (G) | DBT 100 | 1350 | 5,9    | 2,8 | 11,4             | 9,5   | 8,0 | 6,8 | 5,6 | 4,0 | 2,2 | -   |  |
| DB 150 (G) | DBT 150 | 1700 | 8,0    | 3,0 | 13,6             | 11,5  | 9,8 | 8,5 | 7,3 | 6,0 | 4,3 | 3,4 |  |

E: maximum emptying level

Mt: lowest level for continuous duty

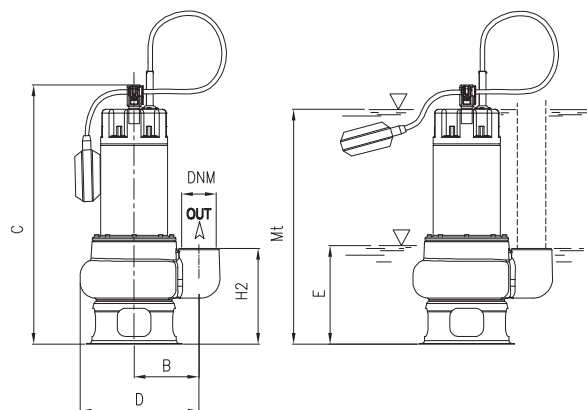

| TYPE       | DIMENSIONS (mm) |     |       |     |     |     |      |     |     |     | <br>Kg |
|------------|-----------------|-----|-------|-----|-----|-----|------|-----|-----|-----|--------|
|            | B               | C   | D     | E   | H2  | Mt  | DNM  | I   | L   | M   |        |
| DB 100 (G) | 142,5           | 461 | 247,5 | 185 | 170 | 390 | 2" G | 200 | 260 | 470 | 17     |
| DB 150 (G) | 142,5           | 461 | 247,5 | 185 | 170 | 390 | 2" G | 200 | 260 | 470 | 18,5   |

